



INSTALLATION MANUAL FOR THE DROP-IN GRANITE SINK

WHAT YOU WILL NEED



drill



silicone
adhesive



jigsaw



pencil



tape
measure



safety
goggles



template
w. sink
dimensions

WHAT YOU SHOULD DO

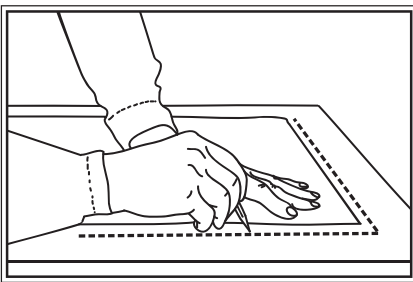

1) Draw the outline of the template in the desired location on the countertop

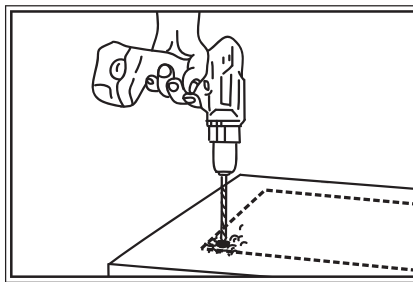

2) Use the drill to make holes in corners of the outline (from its inside)

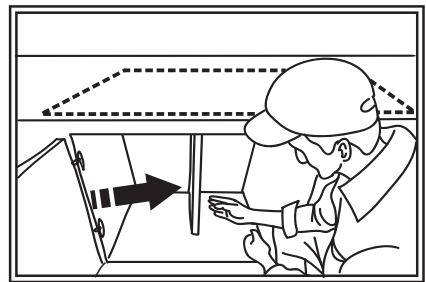

3) Place a bracket under the part of the countertop that you plan to cut out.

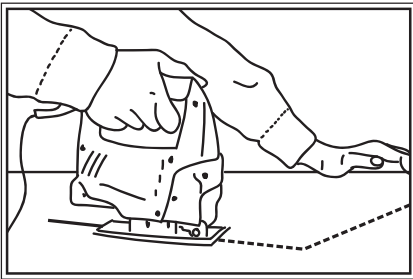

4) Cut the marked outline in the cabinet with a jigsaw

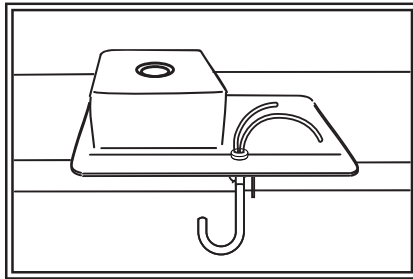

5) Lay the sink upside down on a table and install faucet and accessories

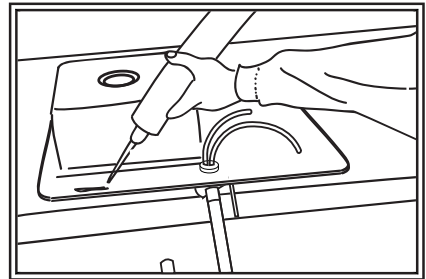

6) Apply a continuous path of silicone to the bottom of the sink frame, approximately 1/4" inside the perimeter

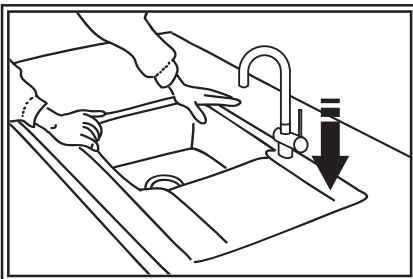

7) Insert the sink into the opening in the countertop, press down and let the silicone dry for 30 mins.

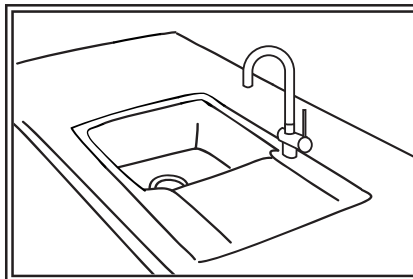

8) Connect the siphon and faucet and enjoy your new Lavello sink